

# Wake Forest Presbyterian Church

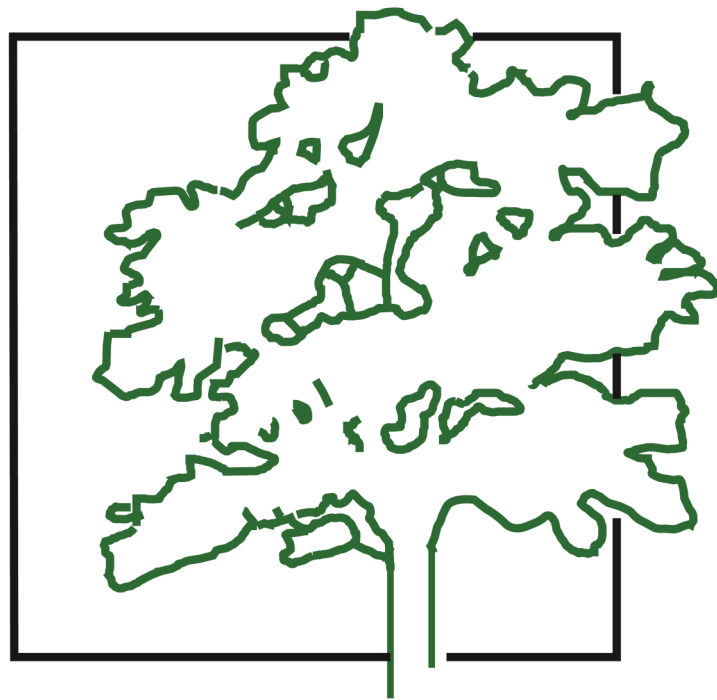

Rooted in Christ

Growing together in faith

Reaching out to others

a guide to our ministries

Fall 2022

# Table of Contents

<b>Introduction</b>	2
<b>Rooted in Christ</b>	
Worship	3
Special Services	4
Music Ministry	5
Bereavement, Baptisms and Weddings	5
<b>Growing together in faith</b>	
Adult Discipleship	6
Youth Ministries	10
Children's Ministries	11
Preschool	12
<b>Reaching out to others</b>	
Mission and Outreach	13
Fellowship	16
Caring for Each Other	17
Walk Through Bethlehem	18
Scouting at WFPC	18
<b>Calendar</b>	19
<b>Campus Map</b>	20
<b>Officers</b>	21
<b>Staff</b>	21

# Introduction

In this guide to Fall 2022 at Wake Forest Presbyterian, we will explore each area of our mission statement...

**Rooted in Christ**

**Growing together in faith**

**Reaching out to others**

...as we seek to fulfill our Vision Statement:

"Wake Forest Presbyterian Church is a Christ-centered congregation, where we seek to grow in our relationship with our Lord, Jesus Christ, and then, in response to God's amazing grace, live out this relationship with Christ in every area of our lives."



We as a church are also coming into a new time together as we journey toward redefining our mission and calling a new head pastor, and we invite you to join us during this exciting time!

Here, we hope to provide you with all the information you need about all the ministries currently planned for WFPC this fall. We hope that you will use this information to stay connected, find community, and join us in our faith journey together.

# Rooted in Christ



## Sunday Worship

*Sundays*

*10:00 AM Worship in the Sanctuary, livestreamed on Facebook and YouTube*

Worship at Wake Forest Presbyterian Church “*joyfully ascribes all praise and honor, glory and power to the Lord... Father, Son and Holy Spirit. In worship, the people of God acknowledge God as present in the world and in our lives. As we respond to God’s claim and redemptive action in Jesus Christ, believers are transformed and renewed. We offer ourselves to God and are better equipped for God’s service in the world.*” [Book of Order, W-1.1001]

Our service features a blend of contemporary and traditional music, which elicits a high level of engagement from the congregation. The service in our sanctuary includes traditional hymns and anthems, as well as sacred pieces by current arrangers and composers, led by the Chancel Choir and our Praise Team.

## Communion

*First Sunday of each month*

On the first Sunday of each month, we celebrate communion together. From the PC(USA): “The Lord's Supper enacts and seals what the Word proclaims: God's sustaining grace offered to all people. The Lord's Supper is at once God's gift of grace, God's means of grace, and God's call to respond to that grace...”

All who accept Jesus Christ as their Lord and Savior are invited to the Communion Table at Wake Forest Presbyterian Church. The grace of God is available wherever we are, and that is something to celebrate! If you are worshipping online, we ask you to have your own elements ready — though we use bread and grape juice at church, anything will work.

## **SPECIAL WORSHIP SERVICES**

### **All Saints Healing and Wholeness Service**

*Tuesday, November 1 at 1 PM and 7 PM in the Sanctuary*

This special worship service is traditionally held near November 1 (All Saints' Day). It is a reminder that we are part of the continuing communion of saints...a time to claim our kinship with those who have gone before us...and a time for the church to be faithful in life and service for all who have been witnesses to God's love in this world. Those who have lost a loved one in the past year may find comfort in this service. Childcare will be provided for the evening service.

### **Blue Christmas Service**

*Tuesday, December 20 7 PM in the Sanctuary*

Christmas can be a time of great joy, but for many it can also be a time of sadness, grief, and loneliness. If you share those feelings, we invite you to come and sit with one another in a liturgy that speaks of the love of God for the grieving.

### **Christmas Eve Services**

*Saturday, December 24 4 PM and 7 PM in the Sanctuary*

We invite you to join us in celebrating the birth of our Savior, Jesus Christ, on Christmas Eve. Each service will include candlelight, music and scripture. Our 4:00 service is specifically designed for families with young children.

## Music Ministry

WFPC's Music Ministry is an open, welcoming, diverse group of loving, dedicated and talented servants whose mission is to share the gospel of Jesus Christ through song; lead and encourage the congregation in both traditional and contemporary worship; and provide an avenue through which individuals may share their gifts and be an integral part of the worship. The music ministry is comprised of the Praise Team, Chancel Choir, Grace Notes Hand Bell Choir, and the Children's Alleluia Choir. There are also opportunities for individuals and groups to share their musical gifts in worship by providing our offertory music. If you have a heart for worship and music, our music ministry is a safe place for you to bring your heart and your gifts to God, to tune in, and to deepen the worship of your heart in a community of believers. If you have questions or feel called to get involved, contact our Director of Music Ministries, Karen Reardon at [karenreardon@wakeforestpres.org](mailto:karenreardon@wakeforestpres.org).

## Bereavement

Wake Forest Presbyterian Church is a caring community of faith that seeks opportunities to support our church family in times of loss. The PCUSA states that "Christians do not bear bereavement in isolation but are sustained by the power of the Spirit and the community of hope." In a time of loss, one of our pastors will work with your family to create a fitting worship service at no charge to our member families. We can also provide funeral receptions, which will be coordinated by our Bereavement Care Team. Please contact one of our pastors at 919-556-7777.

## Baptisms

By presenting yourself or your child for baptism, you announce your faith in Jesus Christ, and show that you want you/your child to know him, love him and serve him as Christ's faithful disciple. The Sacrament of Baptism is performed during our Worship Service and is open to all ages. Because it involves a commitment on the part of the congregation, baptism at WFPC is open only to members and their children. Please contact the church office at 919-556-7777 or [secretary@wakeforestpres.org](mailto:secretary@wakeforestpres.org).

## Weddings

At Wake Forest Presbyterian we are happy to celebrate the sacrament of marriage for members and those whose parents are members of our church. We have a wedding team who will help you to prepare for this special day and be there with you to make sure everything goes well. Please contact the church office at 919-556-7777 or [secretary@wakeforestpres.org](mailto:secretary@wakeforestpres.org).



# Growing together in faith

*Everyone at Wake Forest Presbyterian is on their own personal faith journey, but it is helpful to have friends along the way to encourage us, hold us accountable, and share in our joy and sorrow. The discipleship ministries at WFPC strive to create safe spaces for all to bring their questions and deepen their relationship with Jesus Christ. We invite you to find this space for yourself!*



## ADULT DISCIPLESHIP

### **Adult Sunday School — 9:00-9:50 AM**

#### **Daughters of the King — in the CLC, room B017**

Daughters of the King is a group of women devoted to studying God's word and applying it to our daily lives as Christians in today's world. We are currently studying *How Happiness Happens* by Max Lucado. We invite you to "drop in" for a visit. Contact Loretta Highfield at [loretta.highfield@gmail.com](mailto:loretta.highfield@gmail.com).

#### **Explorations — in the CLC, room B018**

The Explorations Class will study the Reflections Bible Study by the Bible Project. The lessons will feature a short podcast or video and reflection questions to help us create space for the biblical story in our lives. We will reflect on topics such as: What matters to God? How can we live in peace in God's family? And what does it mean for Jesus to be the "I am"? In order for us to also participate in the class co-facilitated by Marguerite and John, we will transition to their study, "Whose Christianity is It? Exploring a Range of Christian Beliefs" from October 2 to November 6. We will finish out the fall with the Reflections Bible Study as well as an Advent lesson. In the spring, we will explore *The Call: The Life and Message of the Apostle Paul*. Contact Ginny Poulsen at [ewpoulsen@gmail.com](mailto:ewpoulsen@gmail.com).

### **Practical Christianity** — *in the CLC, room B105*

This class is designed to look at what it means to be a Presbyterian living in today's world. This fall we'll be looking at the Gospel of John using the book *John* by Mark A. Matson. John & Gayle Akerman will be the facilitators of these classes supported in conversation and fellowship by everyone who attends. Contact John Akerman at Jakerman73@gmail.com or Gayle Akerman at Akerman.Gayle@gmail.com.

### **Reading Scripture: Yesterday and Today** — *in the CLC, room B103*

"The words of scripture . . . become a reality only when they touch the minds and hearts of sentient beings, according to the different needs of each." Karen Armstrong, *The Lost Art of Scripture*, p. 201. Join in our study of Holy Scripture each Sunday morning this fall as we continue our study of the Gospel of John. Just as our class name says, we will Read Scripture. We will recognize that it comes to us from Yesterday, we will read it Today. Contact: keat.wiles@gmail.com.

### **Stumbling Disciples** — *in the CLC, room B106*

Navigating life's curvy and sometimes bumpy road can be a struggle. Together the Stumbling Disciples will use God's word as our "GPS" to guide us through the hurdles of parenting, support us as we face the future with aging parents and nurture our marriages that have sometimes been neglected from the busyness of life. Please join us as we laugh, learn and lean on God through the joys and challenges of life. Contact: ellencutler19@gmail.com or 919-414-2753

### **Tell Me More** – *September 11-25 in the CLC, room B104*

The pastors and elders will meet with all of our friends who are not yet members of Wake Forest Presbyterian and would like to learn about the benefits. One of the more unusual benefits of joining at this time is that you will have a vote when it comes time to elect a new pastor! But there's so much more to the Presbyterian Church USA than voting on matters. Come learn the foundations of our faith and how it shapes the way we do most everything around here. Members, too, are invited if any of you would like to "get reacquainted" with your church and denomination! Contact: normbrown21958@gmail.com

### **Whose Christianity is It? Exploring a Range of Christian Beliefs** – *in the CLC, downstairs*

Marguerite and John will be co-facilitating an elective class being offered at 9 a.m. in the CLC October 2 - November 6. Come to all or just come to one, your choice. Youth and adults are welcome, as are any existing Sunday School classes that would like to join us for any sessions that interest them.

The goal for this elective series is to equip our learners so they can articulate both sides of the modern Christian spectrum to better define who we are as a denomination, who we are as WFPC, and where the learner lands on the spectrum. At July's 225th General Assembly, votes were taken on several of these issues that show the range of theological diversity within the PCUSA denomination as well as Christendom as a whole. The goal is not to make anyone believe what someone else believes. The goal is to present a picture of God's kingdom where the wolf lies down with the lamb, and we find we can reasonably share with and learn from perspectives different from ours. Contact: margueritesirrine@wakeforestpres.org (See next page for a detailed schedule.)



Oct 2	Inerrancy of Scripture
Oct 9	Role of Women in Church and Culture
Oct 16	Racial Equity and Christian Nationalism
Oct 23	Is PCUSA the church of the Democratic Party and evangelical Christians the church of the Republican Party?
Oct 30	LGBTQIA+ – Scripture and Gender Neutrality
Nov 6	Is the PCUSA Secularism in Sheep's Clothing or the Prophetic Witness to God's New Creation?

## **Adult Small Groups**

**Iron Sharpens Iron Wednesdays** — *Wednesdays at 6:45 PM via Zoom (with some in-person)*

Iron Sharpens Iron tends to go deep by focusing on how scripture informs our day-to-day lives.

Our Wednesday night group will be using the book *Made for a Miracle* by Mike Slaughter and focus on the two components of every miracle: divine action and human responsibility. Contact Keith Thomas at keithbthomas007@gmail.com.

**Iron Sharpens Iron Saturdays** — *Saturdays at 8:00 AM in the CLC, room B017*

Why do several men make time in their Saturday mornings to join together? To provide some insight, here is a snip from our group covenant that we recite at the start of each meeting: *We gather together with one purpose in mind... to become better disciples of Jesus Christ. We do this by encouraging one another to keep His commands and resist temptation. Through the grace of mutual accountability, our aim is to encourage each other and to accept Christ into our lives and permit the Holy Spirit to lead us to love and good works.* Our method for moving us forward in our walk with Jesus is to read Christian books and chapters of the Bible together, exploring the contents and discussing how we can use these concepts to improve our discipleship and our relationships with Jesus, and all of the mortals in our lives, as well. We each take turns leading the weekly discussions to ensure this role does not become a burden to anyone. We look forward to adding new perspectives to our weekly adventures - thank you for considering joining us each Saturday morning at 8 am in the CLC. Contact Rob Patterson at nchokiefan@gmail.com.

**Morning Glory Circle** — 2nd/4th Thursdays at 10:00 AM in the CLC, room B017

The Morning Glory Circle invites you to join us as we explore the teachings of Jesus through our study of *The Forty Parables of Jesus* by Gerhard Lohfink. We meet at church in the classroom next to the kitchen at 10:00 on the 2nd and 4th Thursdays of each month starting on September 8. Please join us as we learn together, enjoy fellowship, support one another through prayer, and reach out with Christ's love to those in need. Contact Brenda Patrick at bpatrick5286@gmail.com.

**Perspectives** — Tuesdays, every five or six weeks, at 7:00 PM offsite

Because the best way to truly understand other people is to see the world through their eyes, Perspectives attempts to do just that by reading and discussing books that express a wide variety of viewpoints about important and sometimes difficult issues. We will be reading both fiction and nonfiction books over the next few months. Our first book this fall will be *Jesus and John Wayne*, and we'll meet to discuss it on October 4. Contact sharonline@nc.rr.com.

**Son Risers** — Fridays at 6:15 AM in the CLC, room B018 and online (hybrid)

We meet on Friday mornings for breakfast, fellowship, prayer and study. The study is for men, husbands, sons, brothers — all male sinners are welcome! Our aim is to uphold each other in our Christian walk and seek God through prayer; study of His Word; honest, open discussion; and laughter. This year we are studying questions in the Bible using *The Jesus Code* by O.S. Hawkins. Contact Andres Esguerra at aesguerra@hotmail.com.

**Women of the Word** — 2nd/4th Tuesdays at 7:00 PM on Zoom

This fall we plan to study *Gentle and Lowly*, by Dane C. Ortlund. *Gentle and Lowly* takes readers into the depths of Christ's very heart for sinners. Focusing on Jesus's words that he is "gentle and lowly in heart," Ortlund dives deep into Bible passages that speak of who he most deeply is, encouraging readers with the affections of Christ for his people. We will also meet in person for some fellowship opportunities. In the winter, we will study, *If You Want to Walk on Water, You've Got to Get Out of the Boat*, by John Ortberg which uses the New Testament account of Jesus walking on water as a conceptual framework for discussing leaps of faith and encouraging readers to make them.

WOW provides lunch and collects needed items for the Raleigh Women's Center monthly. We started serving this ministry during the pandemic. Interested in joining us, please reach out to Mary Beichner, marybeichner@me.com, Athy Robinson, athyrobison@gmail.com, or Sandie Buda, sandiebuda@nc.rr.com.

# **YOUTH MINISTRIES**

WFPC youth are all about gathering together and experiencing fellowship, food, fun, songs — the list goes on! This church family welcomes you AS YOU ARE, as a beloved child of God! Relationships are an important part of Youth Ministries at Wake Forest Presbyterian Church. We believe that God calls us to live in community and to care for one another just as Jesus loved and cared for His disciples and the people He taught, healed, and saved! Get involved and stay connected! If you have any questions about Youth Ministries or would like to be added to the weekly email, please contact our Director of Youth Ministries, Janet Briley, at [youth@wakeforestpres.org](mailto:youth@wakeforestpres.org).

## **Sunday Mornings** *Discipleship Hour, 9:00-9:50 AM*

**Confirmation:** 8th and 9th graders; registration required. This class will start on October 9, 2022. Stay tuned for more details!

**Middle School and High School Sunday School:** 6th-8th graders will meet in the Green Mod Room 3; 9th-12th graders will meet in the Youth Room. (Note — starting October 9, 8th and 9th graders registered for Confirmation will move to that class.)

## **Sunday Afternoons**

- **Middle School Youth Group** (6th-8th grade) will meet in the Youth Room and CLC from 4:30 - 6:00 PM.
- **High School Youth Group** (9th-12th grade) will meet in the Youth Room and CLC from 6:00-7:30 PM.
- **Youth Band** — Do you play an instrument? Sing? Join us to see what this is all about! We will meet on Sunday evenings following high school youth group from 7:30 PM to 8:30 PM.

## **Wednesday Evenings** *September 28, October 12, October 26, November 2, November 9*

On Wednesday evenings this fall, we will meet from 6:00-7:00. Middle school and high school youth are invited to participate in:

- Open Gym in the CLC OR
- Board Games and Fellowship in the Youth Room

## **And More!!**

There's a lot more planned for the WFPC youth in fall 2020 and beyond. If you're interested, please contact Janet at [youth@wakeforestpres.org](mailto:youth@wakeforestpres.org) and ask for the **2022/2023 Youth Ministries Packet**. Also ask to be added to the weekly email list so you can stay up to date with everything that's going on!

# **CHILDREN'S MINISTRIES**

## **Sunday Mornings**

9:00-9:50      *Discipleship Hour with Sunday School Classes for kindergarten through 5th grade*

11:00-11:50      *Worship in the Sanctuary with Children's Church Corner*

**NURSERY CARE** for children birth to 4 years old is provided every Sunday anytime between 8:45-11:15.

**CHILDREN'S CHURCH CORNER** (4 years old through 3rd grade) is IN the worship space! Following Children's Time, join us for quiet activities, kid-sized relaxing chairs, and bulletins. Children are welcome to come spend time in the children's corner or take activities and return to their parents!

## **Alleluia Singers** *Sundays, after worship service, for kindergarten through 5th Grade*

Alleluia Singers choir returns weekly beginning September 7. All children are invited to come learn songs that will be sung in worship, led by our Alleluia Singers! Singing schedule TBD.

## **Club 4/5** *September 18, October 2, 16 & 30, November 6, & December 9*

Get ready all current 4th and 5th graders! Club 4/5 is coming BACK! We will do LOTS of different activities, field trips, etc. This will be YOUR special space that gets you ready to jump into youth group in middle school, and lets you be the big kid you are!

## **Prep for Worship** *Sundays, 9:00-9:50 AM, October 2—November 13*

Do you have a child currently in 3rd or 4th grade? Or perhaps your child missed out on our Prep for Worship Class in the past? We will have a five-week Prep for Worship class during the Discipleship hour this year. Prep for Worship Bible presentations will take place in worship on November 13. Registration will begin mid September!

## **Advent Adventures** *November 13-15, 6:00-8:00 PM*

Info Coming SOON! A three night Advent-focused VBS style event to run November 13-15, ending with dinner and our annual Advent Festival on the 16th!

## **Wednesday Night Activities** *September 28, October 12 & 26, November 2 & 9*

5-6 pm      open gym in the CLC for kids k-5th grade (planned activities each week)

6-6:30 pm      pizza

6:30-8 pm      fire fellowship for all ages with s'mores

## **And there's always MORE!!**

We're always adding activities. To be added to the weekly children's email to stay up-to-date, email Katherine Peiper at [katherinepeiper@wakeforestpres.org](mailto:katherinepeiper@wakeforestpres.org)

# **WAKE FOREST PRESBYTERIAN PRESCHOOL**

## **Mission**

Our Mission is to provide a loving Christian program that will minister to children, their parents, and the staff that cares for them.

We encourage many areas of a child's development — spiritual, cognitive, social, physical, and emotional — by providing a safe, nurturing environment and developmentally appropriate activities. We will seek to awaken each child's love of learning and sense of wonder. Our Christian atmosphere will help children realize their value and responsibilities as children of God.

We recognize the important role of parents as partners in their children's education and strongly encourage active participation. We want to foster an atmosphere of support and fellowship for these parents. We will maintain strong communications to keep parents abreast of the school's activities and their children's progress. We realize you are your child's most important advocate.

We value our teachers and staff and want to provide them with a pleasant and meaningful working environment that allows them to grow personally, spiritually, and professionally. We are dedicated to giving them the support they need to help their students achieve the objectives set out for them and to maintain a safe and happy classroom.

## **Developmentally Appropriate Learning**

We develop our curriculum to meet your child's specific developmental needs, using a variety of experiences to ensure a great educational foundation and kindergarten readiness. Literary Activities develop reading readiness, encourage curiosity, enhance listening skills, and let us explore the world around us. Sensory Experiences teach about nature, science, physics, math, categorization and patterns, while encouraging eye-hand coordination and fine-tuning different senses. Structure in our preschool day teaches successful strategies for classroom behavior, builds awareness of time concepts and sequence, and bolsters self-discipline and independence. Art Activities develop fine motor skills, familiarize us with colors and shapes, master pre-writing skills, help us to use scissors, and encourage creativity and imagination. Dramatic and Outdoor Play enhance social skills, teach problem solving, encourage imagination, and build gross motor skills.

## **Classes** *Labor Day through mid-May, Monday through Friday, 9:15-12:15*

2 year old, 2 days a week (Tuesday/Thursday)

3 year old, 3 days a week (Monday/Wednesday/Friday)

4 year old, 4 days a week (Monday through Thursday)

4 year old, 5 days a week (Monday through Friday)

Transitional Kindergarten, 5 days a week (Monday through Friday)

## **Contact**

Preschool Director Dawn Brown at [preschooldirector@wakeforestpres.org](mailto:preschooldirector@wakeforestpres.org) or 919-488-1820



# Reaching out to others

*We are reaching out to others both inside the congregation of Wake Forest Presbyterian and beyond our church walls into the greater community. Read on to see how we are doing that through a wide-ranging collection of ministries.*



## **MISSION AND OUTREACH**

Reaching out to others is part of the DNA of Wake Forest Presbyterian.

### **Adult Mission Trip** *September 11-16*

In 2005, after the devastation of Hurricane Katrina on the Gulf Coast of the U.S., a group was formed to respond to this natural disaster and a ministry was formed. Groups of adults have traveled and assisted in other areas of the country with disaster recovery, mostly through the PC(USA) division of Presbyterian Disaster Relief in the years since that first trip. In recent years, the trips have been to communities in Eastern NC still impacted by the storms that come year after year. Planning is underway for a trip this Fall which will take place September 11-16. Contact: Judy Finch Ide at [jfinchide@hotmail.com](mailto:jfinchide@hotmail.com) for more information or to sign up as a volunteer for future trips.

### **Backpack Buddies**

This ongoing ministry helps to feed children in our community. We partner with three local elementary and middle schools to supply food-insecure children meals they can take home over the weekend when they don't have regular access to school meals. If you'd like to help, we are packing weekly meals of canned food items and delivering them for distribution to the schools. If you'd like to donate food we routinely use canned soups, ramen noodles, canned chicken and tuna, canned pasta, mac n cheese, canned vegetables, canned fruit, canned chili, Pop-Tarts, oatmeal and juice boxes. (No glass please, and easy open

tab tops are always preferred.) Food donations may be dropped off in the collection bins located in the Narthex Donation closet or at the collection table near the CLC entrance near the parking lot. If you would like to volunteer in any way to support this program, please email Heather Wheeler at [heathersb73@yahoo.com](mailto:heathersb73@yahoo.com) for more information.

### **Blood Drive** *October 2 at WFPC*

WFPC partners with The Blood Connection (TBC) to host three blood drives a year. TBC is a community blood supplier primarily serving NC, SC and GA. Donors provide lifesaving blood to neighbors and friends in our region. There are opportunities to not only donate blood but to volunteer time to facilitate each drive's success. During the pandemic, the need for blood is especially great, and TBC has developed safety protocols to ensure the safety of its donors and volunteers. Our next blood drive is scheduled for October 2nd. Contact: Gary Skinner at [garyskinnerwf@gmail.com](mailto:garyskinnerwf@gmail.com).

### **Christmas Angel**

During the Christmas season, WFPC helps to spread joy in the Wake Forest community through supporting children and families in need as identified through our local social service agency. This year we will be having a giving tree (located in the Narthex) which will have names of people identified by social services that are in need of assistance. Contact Carol Winans-Geiser at [carol@winans.com](mailto:carol@winans.com) for more information.

### **Community Garden**

WFPC's Giving Garden provides seasonal fruits and vegetables to over 100 households with food insecurity per week, year-round. There is always a variety of work to be done in the garden, suitable to different ages and ability levels. With our commitment to making our garden user friendly, we have installed table planters for adults and children, including wheelchair accessible planters. We also have a shade tent and a misting station to provide heat relief in the summer months. Participation in the Giving Garden is open to the community, and visitors are welcome. Contact Pam Schulze [wfpccgivinggarden@gmail.com](mailto:wfpccgivinggarden@gmail.com).

### **CROP Walk** *September 18 at WFPC*

The CROP Walk is a great mission that helps bring the reality of global hunger to the surface. The rise of people impacted by these COVID-19 times has only meant that food insecurity and meal insecurity are on the rise -- locally, nationally, and globally. You can sign up to join the team at <https://events.crophungerwalk.org/2022/event/trianglenc>

## **Family Promise**

Family Promise, formerly Wake Interfaith Hospitality Network (WIHN), along with area churches, provides professional case management as well as food, shelter and transportation for families experiencing homelessness as they work to restore their independence. Churches provide food and fellowship to families during a one-week stay at the church facilities. Families stay overnight in the church and in the mornings are transported to the Family Promise center in Raleigh for the day where they are provided with day care for their children, transportation, transitional housing assistance, job placement assistance, financial counseling, family crisis counseling and much more. Families return to the church later in the day where they are hosted with dinner and fellowship. COVID has put this mission into a state of flux, and we are awaiting word from Family Promise to let us know when they've resumed asking churches to host on-site. Currently, WFPC hosts families for two weeks per year. Contacts are Trish Floyd at [pjfloydgo@gmail.com](mailto:pjfloydgo@gmail.com) and Charlene Shaffer at [charjshaffer@gmail.com](mailto:charjshaffer@gmail.com).

## **Journey Ministry Food Pantry**

The Journey Ministry Pantry ([thejourneyministrypantry.com](http://thejourneyministrypantry.com)) is a faith-based nonprofit organization in Youngsville providing food to needy families in Franklin and surrounding counties. It currently serves about 30 families, and is expected to double in the coming months. Volunteers collect donated food from local grocery stores, supplemented with private donations and donations from local churches, including WFPC. The WFPC community garden has been providing fresh vegetables to the Pantry for the past few years. Journey welcomes volunteers to pick up food at local grocery stores, pack the boxes we hand out, and assist with food distribution on Tuesday afternoons. Quarterly, on Saturday mornings (next dates are September 3 and December 3), the Food Bank provides a truckload of food for the pantry to hand out to families in need. Help is needed from 6:30 am to noon (or whatever time you can work) unloading the truck, setting up, handing out food, and cleanup. For additional information, please contact Paul Swartz at [swartzp51@gmail.com](mailto:swartzp51@gmail.com) or 919-215-6216.

## **Si Seiler Golf Outing** *October 1 at 1:00*

The annual fall Mission and Outreach Golf Tournament (now known as the "Si Seiler Golf Outing") will take place on October 1 at 1:00 pm at the Wendell Country Club, with a rain date of October 8. Dinner for this event will take place immediately afterwards at the clubhouse. Various sponsorships are available. Golfers of all skill levels are welcome.

## **VA Veteran's Ministry**

This ministry works to support the Durham VA Volunteer Office and food-insecure veterans.. Twice yearly, on Memorial Day and Veterans Day weekend, we hold an all-day food drive at Lowes Foods (across from the church). The proceeds are then delivered monthly to the VA Volunteer Office emergency food pantry for veterans in need. The food donated from the drives as well as purchased food (when needed) is delivered monthly to the Durham VA for the food-insecure veterans. The food drive dates will be close to Memorial Day and Veterans Day on a Saturday. Contact Benny Hoots at [rhoots@nc.rr.com](mailto:rhoots@nc.rr.com) or Bonnie Hoots at [momhoots@nc.rr.com](mailto:momhoots@nc.rr.com).

# **FELLOWSHIP**

## **SUNDAY MORNING FELLOWSHIP** *Sundays, 8:30-11:30 in narthex (lobby)*

Before you head to Sunday School or worship, we invite you to grab a cup of coffee (or tea) at our Holy Grounds Coffee Fellowship. After the worship service, we invite your family to stop by in the narthex (lobby) to share some light refreshments and get better acquainted with your church family.

## **MISSION STUDY DINNERS** *September 21, October 5 and October 19 in the CLC*

We need EVERYONE'S voice at all three sessions to engage in the conversation with the Scripture Study and the Mission Study Team's presentation of information so that we can discern where God is calling WFPC to use its gifts to the best advantage of the community we are called to serve. This is a critical step as we journey toward calling a new pastor! Catered dinner will be provided (no charge) and all ages are welcome and encouraged to attend.

## **HOLY HAY DAY** *Sunday, October 23, 11:30-1:00 outside*

FUN FOR ALL AGES!!! We will have homemade BBQ plates, live music, games, pumpkin painting, 50/50 raffle, costume parade, and so much more!!!! This event will once again be hosted by the youth of WFPC and all proceeds go toward their mission trips and faith formation retreats. We can't wait to see you there!!

## **BLESSING OF THE PETS** *Wednesday, September 14 at 6:30 outside*

We know how beloved our furry (or scaly, or feathery) family is to us, and how much joy and meaning they can add to our lives, so we want to honor their presence in our world! Bring your pet(s) to the lawn outside our rose garden for special recognition and a blessing by our pastors! All pets are welcome, costumes on pets are invited, smiles and joy are guaranteed! :) \*\*please plan on keeping leashes on pets at all times.

## **ADVENT FESTIVAL** *Wednesday, November 16, 5:30-7:30 pm in the CLC*

Our Annual Advent Festival is a time for ALL ages and stages to gather, eat together, and to create some Christmas magic! We will have crafting stations including bow making, advent wreath making, cookie decorating, ornament making, etc., manned by experts, where you can learn to create your own Christmas crafts!. There will be something for everyone, all ages and abilities. Soup and sandwich dinner will be provided. Contact [katherinepeiper@wakeforetspres.org](mailto:katherinepeiper@wakeforetspres.org)

## **FIRE FELLOWSHIP** *September 28, October 12 & 26, November 2 & 9, 6:30-7:45 PM*

Come one come all, gather around the fire for conversation, fellowship, and SMORES! There will be no agenda, no topics, just time to be together as a church family. ALL ages and stages are welcome and encouraged to bring a chair and join in!

### **JOY GROUP** *September 9, October 12, November 9 and December 9 at 12 noon*

Our JOY Group (Just Older Youth) traditionally has come together each month and begins their lunch meetings with fellowship time. We are still in discussions as to how we will safely gather this fall with a combination of church and restaurant locations. If you are interested in becoming a part of this group of the young-at-heart, please contact [joy@wakeforestpres.org](mailto:joy@wakeforestpres.org).

## **CARING FOR EACH OTHER**

### **DEACONS**

The Diaconate of WFPC is made up of elected officers who form teams to handle Branch Ministry, Compassion and Encouragement, Fellowship and Events, and Welcome. If you don't know who your deacon is, contact [info@wakeforestpres.org](mailto:info@wakeforestpres.org), and we will get you in touch with them.

### **STEPHEN MINISTRY**

A Stephen Minister is a Christian that provides confidential one-on-one care to individuals who are experiencing stressors in their lives. Examples of one-on-one care are listening and praying with and for a care receiver about life-altering events (divorce, illness, grief, parenting, job crisis, aging, spiritual crisis, empty nesting, incarceration, etc...) For more information on how to receive a Stephen Minister or to inquire more about the ministry, please contact one of the following: Barbara Winch at [barbarawinch@bellsouth.net](mailto:barbarawinch@bellsouth.net) or Armin Harrell at [arminharrell48@gmail.com](mailto:arminharrell48@gmail.com)

### **GRIEF SHARE** *Thursdays, September 15 - December 15, 5:00-6:30 pm in CLC Room B104*

The care you need. Information you can trust. After the funeral, when the cards and flowers have stopped coming, most of the people around you return to their normal lives. But your grief continues and you feel alone. Often friends and family want to help you, but don't know how. That's the reason for GriefShare. Our group is led by caring people who have experienced grief and have successfully rebuilt their lives. We understand how you feel because we've been in the same place. We will walk with you on the long path through grief toward healing and hope for the future. GriefShare is a support group that meets weekly. You'll find it to be a warm, caring environment and will come to see your group as an "oasis" on your long journey through grief. Contact Rick Mayo at [rmayo86913@aol.com](mailto:rmayo86913@aol.com). There are three key parts to your GriefShare experience:

- Video seminar - Encouraging, information packed videos featuring leading grief recovery experts.
- Support group - Small discussion group about weekly video content.
- Workbook - Journaling and personal study exercises that reinforce the weekly session topics.

### **KNITTING MINISTRY** *1st Thursday of each month, 10:00 am in CLC Room B017*

This group of knitters and crocheters share their talents by making prayer shawls that are gifted to those in our community who need to feel the warmth of God's love. Contact Jan McCloud at [mccloudj22@gmail.com](mailto:mccloudj22@gmail.com).



## **DEMENTIA CAREGIVER CLASS** *3rd Wednesday: in-person 10-11:30 AM; Zoom 2-3:30 PM*

Our mission is to educate, encourage, and empower dementia caregivers in the Wake Forest community. Each class is designed to provide practical tools for caregivers so that participants always leave a class with new knowledge that can be applied to best support the person living with dementia as well as the caregivers themselves. We begin with a devotional and prayer that is specifically chosen to reinforce the training content. Topics for classes will be published in Leaflets and in Sunday bulletins. Please join us at any time if you are the caregiver for someone with dementia, a family member or friend of someone with dementia, or if you just want to learn more. We hope to begin in-person meetings in October, but the date for in-person meetings will depend upon the availability of appropriate audiovisual equipment and the status of Covid-19 spread in the community. When we resume in-person classes, we will continue to stream classes via Zoom to ensure access for those who cannot otherwise attend.

In addition to classes, we also offer individual consultations with caregivers via Zoom or in-person on Pat or Lynette's screened porch. For additional information or to be added to class emails, contact Pat Snyder at [patsnyder137@gmail.com](mailto:patsnyder137@gmail.com) or Lynette Wilson at [lynettesywilson@nc.rr.com](mailto:lynettesywilson@nc.rr.com). (*Note — in-person classes are slated to begin in October. Our December classes will meet on December 14, not December 21.*)

## **WALK THROUGH BETHLEHEM** *December 2, 3, & 4*

Walk Through Bethlehem is back live after two years off for the COVID pandemic. The 2022 dates are Friday, December 2, Saturday, December 3, and Sunday, December 4. Hours are 6 - 9 pm on Friday, 5 - 9 pm on Saturday, and 5 - 8 pm on Sunday. Mark your calendars now!

For more information or to sign up, contact Kathy Drake at [katdrake32@gmail.com](mailto:katdrake32@gmail.com) or 919-880-5382 or check out this link: <https://m.signupgenius.com/#/showSignUp/60BoD45ADAE2EABg-walk>

## **SCOUTING AT WFPC**

Our Boy Scout Troop went to two separate Scout camps this summer. Six Scouts and two adult leaders went to Sea Base in the Florida Keys for a week on a sail boat and various ocean related activities. Another group of 20 Scouts and four leaders went to a week-long camp at Raven Knob Scout camp near Mt. Airy, NC. They participated in a variety of merit badge classes including swimming, sailing, paddle boarding, rifle and shotgun shooting, geocaching, wilderness survival and even aviation and space exploration to name a few. Unfortunately, due to the inability to meet due to the pandemic and a lack of parent volunteers, our Cub Scout pack folded. We would like to restart it if we can find interested youth and parent volunteers. The Scout troop begins regular meetings again this fall, Monday nights in the CLC at 7:15 pm. If you have interest in joining our Troop or Pack, you can contact Greg Howard, our Scout Master, at [ghoward@troop5wf.com](mailto:ghoward@troop5wf.com) or Jim Wills at [jimdanawills@gmail.com](mailto:jimdanawills@gmail.com). The Troop's website is [www.troopwebhost.org/Troop5WakeForest/Index.htm](http://www.troopwebhost.org/Troop5WakeForest/Index.htm)

# WFPC Fall 2022 Calendar Highlights

## September

9	JOY Group
11	Rally Day (our 2022/2023 ministry year begins!) Youth Kickoff
14	Pet Blessing
18	Congregational Meeting (to elect new officers) CROP Walk Club 4/5 Kickoff Youth Group begins (weekly)
21	Mission Study Congregational Dinner #1
25	Prep for Worship Begins
28	Wednesday Night Activities
30-10/2	Middle School Retreat

## October

1	Si Seiler Golf Outing
2	World Communion Sunday Blood Drive Club 4/5
5	Mission Study Congregational Dinner #2
12	Wednesday Night Activities
14	JOY Group
16	Club 4/5
19	Mission Study Congregational Dinner #3
23	Holy Hay Day
26	Wednesday Night Activities
30	Club 4/5

## November

1	All Saints' Healing and Wholeness Service
2	Wednesday Night Activities
6	Club 4/5
11	JOY Group
12	Veterans' Day Food Drive
13-15	Advent Adventure
17	Advent Festival
21	Club 4/5
27	Advent Begins

## December

2-4	Walk Through Bethlehem
9	JOY Group Club 4/5 Christmas Party
11	Youth Random Acts of Kindness
20	Blue Christmas Service
24	Christmas Eve Services
25	No Sunday School

# Campus Map

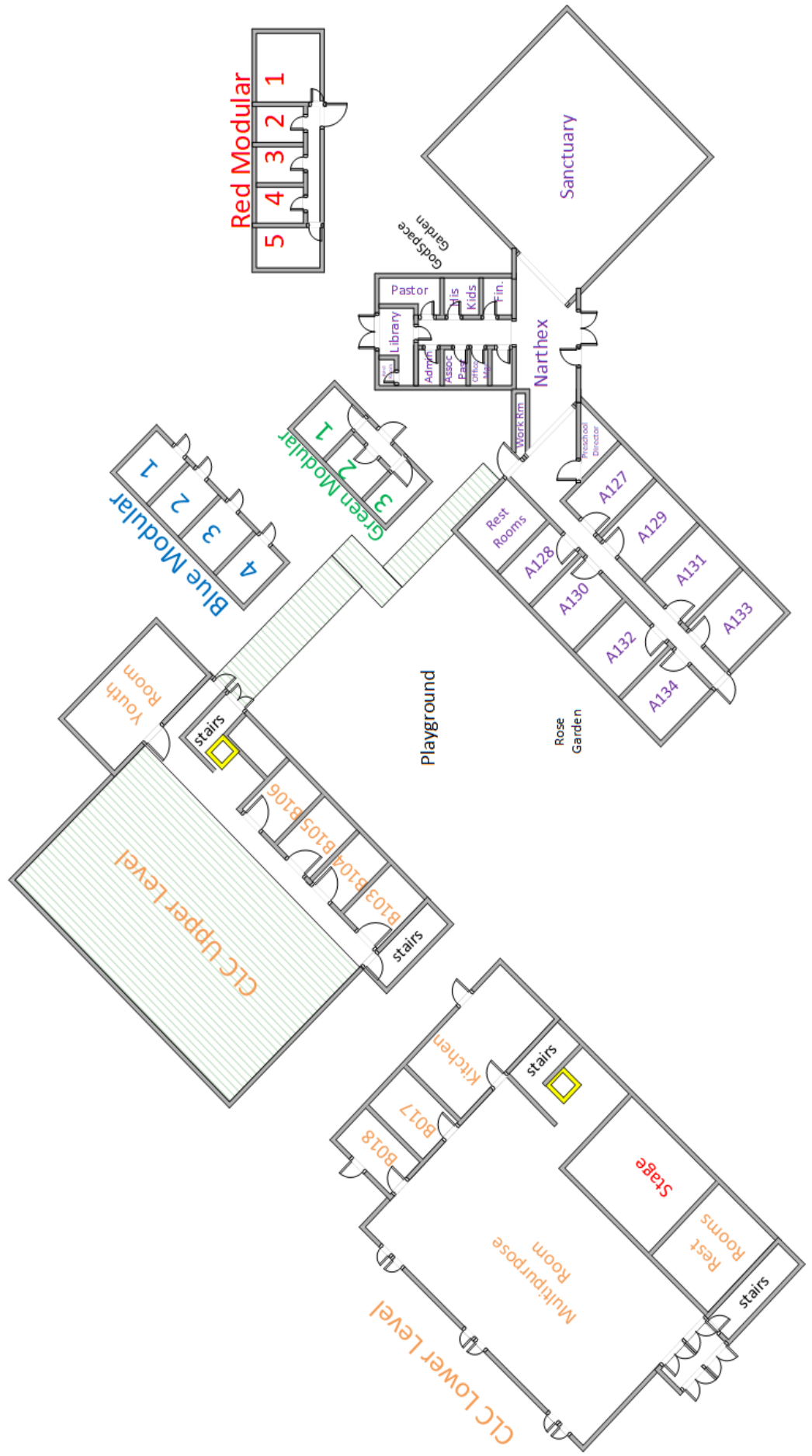

# **WAKE FOREST PRESBYTERIAN CHURCH OFFICERS**

## **ELDERS (SESSION)**

Stated Clerk: Sarah Kirby (2023)

### **Class of 2022**

Dania Borowitz (Disc., Children)  
Trish Floyd (Congregational Care)  
Sharon Lineberry (Disc. Adult)  
Randy Parrish (Mission)  
Ed Pulliam (Finance)  
Jim Wills (Facilities)

### **Class of 2023**

Kathy Drake (Worship)  
Denny Ide (Facilities)  
Amanda McCabe (Personnel)  
Chad Robertson (IT/Commun.)

### **Class of 2024**

John Akerman (Generosity)  
Joni Amerson (Worship)  
Norm Brown (MEG)  
Seamus Duerr (IT/Commun.)  
Dawn Myers (Disc. Youth)  
Harold Panel (Personnel)  
Kathy Tharrington (Mission)

## **DEACONS (DIACONATE)**

Moderator of the Deacons: Trish Floyd

Clerk: Lucy Deeprose

### **Class of 2022**

Paul Ballance (Welcome)  
George Dudley (Branch Ministry)  
Pat Snyder (Compassion)

### **Class of 2023**

Ann Brackett (Branch)  
Sarah Chapman (Fellowship)  
Bonnie Habicht (Fellowship)  
Pat Snyder (Compassion)

### **Class of 2024**

Karla Frye (Welcome)  
Mike Honkomp (Fellowship)  
Traci Marchand (Compassion)  
Carol Noble (Fellowship)

# **WAKE FOREST PRESBYTERIAN CHURCH STAFF**

Marguerite Sirrine	Transitional Pastor	<a href="mailto:margueritesirrine@wakeforestpres.org">margueritesirrine@wakeforestpres.org</a>
John Fawcett	Associate Pastor	<a href="mailto:johnfawcett@wakeforestpres.org">johnfawcett@wakeforestpres.org</a>
Katherine Peiper	Director of Children, Family & Youth	<a href="mailto:katherinepeiper@wakeforestpres.org">katherinepeiper@wakeforestpres.org</a>
Karen Reardon	Traditional Music Ministry Director	<a href="mailto:karenreardon@wakeforestpres.org">karenreardon@wakeforestpres.org</a>
Dawn Brown	Preschool Director	<a href="mailto:dawnbrown@wakeforestpres.org">dawnbrown@wakeforestpres.org</a>
Janet Briley	Director of Youth Ministries	<a href="mailto:youth@wakeforestpres.org">youth@wakeforestpres.org</a>
Amy Cebrick	Asst. Director of Children's Ministries	<a href="mailto:hiskids@wakeforestpres.org">hiskids@wakeforestpres.org</a>
Jermaine Taylor	Director of A/V and Media	<a href="mailto:jermainetaylor@wakeforestpres.org">jermainetaylor@wakeforestpres.org</a>
Renee Engel	Executive Assistant	<a href="mailto:secretary@wakeforestpres.org">secretary@wakeforestpres.org</a>
Cindy Shriver	Business Office Administrator	<a href="mailto:officeadmin@wakeforestpres.org">officeadmin@wakeforestpres.org</a>
Joanne Lambert	Financial Administrator	<a href="mailto:financials@wakeforestpres.org">financials@wakeforestpres.org</a>
Ed Tharrington	Temp. Contemporary Music Director	

**Wake Forest Presbyterian Church**

**12605 Capital Boulevard**

**Wake Forest, NC 27587**

**919-556-7777**

**[wakeforestpres.org](http://wakeforestpres.org)**